

CMCP200MK Keyed Targets for Magnetic Bases



Adhesive Mount

Bolt On

Features

- 1.2" (30.5 mm) Diameter Mounting Pad
- Keyed For Two Pole Magnets
- Sets Proper Sensor Orientation
- 416 Stainless Steel (Ferrous Steel)
- Adhesive Mount or Bolt On
- Compatible with STI MB Series Magnets
- Compatible with Emerson Triax with Integral Magnet
- Spiral Backing on Adhesive Mount for Improved Strength

Typical Applications

Keyed Targets are Mounting Pads used to provide a quality surface to attach Accelerometers with a Magnetic Base. By ensuring a smooth surface and in case of the Bolt On version a perpendicular mounting hole, they expand the sensor's frequency response, set the proper orientation and improve the repeatability of data collection. Accelerometer Mounting Pads may be either bolt mounted (Bolt On), or epoxy mounted (Adhesive Mount) to the prepared area of the machine's bearing housing. Keyed Targets are for Portable Data Collection to ensure location and orientation repeatability, resulting in quality data for trending and analysis.

Compatible with STI's Magnetic Bases CMCP-MB02, CMCP-MB03 and CMCP-MB10 as well as Emerson's Triaxial Accelerometer with Integral Magnet A0643TX-EX.

Mechanical

Case Material:	416 Stainless Steel
Diameter:	1.2" (30.5 mm)
Key Height:	0.1" (2.54 mm)
Key Width:	0.38" (9.65 mm)
Mounting:	
CMCP200MK-E	Adhesive Mount
CMCP200MK-B	0.27" Countersunk Bolt Hole (for ¼-28 or M8x1.25)
Drill Standard Minimum:	0.25" deep

Dimensions

CMCP200MK-E Adhesive Mount

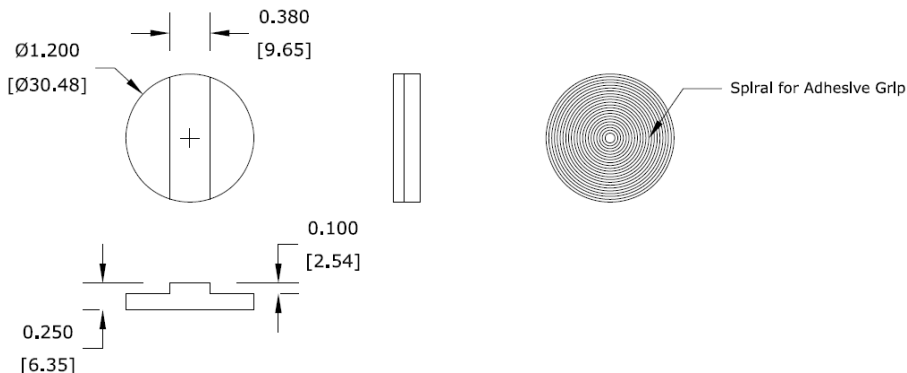

CMCP200MK-B Bolt On

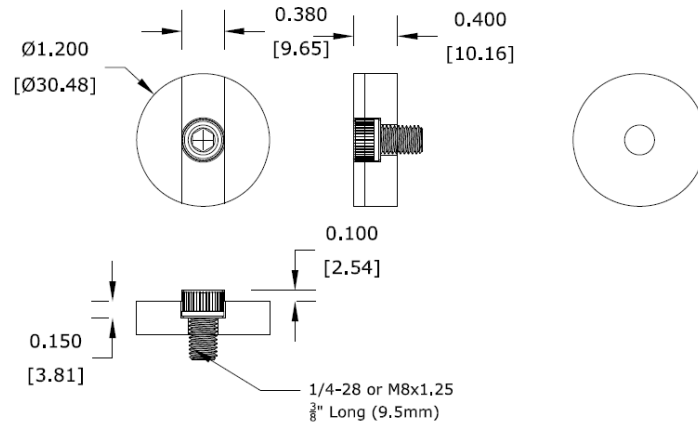

Ordering Information

CMCP200MK-E	Keyed Target for Adhesive Mount
CMCP200MK-E-050	Keyed Target for Adhesive Mount, Pack of 50
CMCP200MK-B	Keyed Target for Bolt Mount, Bolt not included
CMCP200MK-B1	Keyed Target for Bolt Mount, 1/4-28 Bolt included
CMCP200MK-B2	Keyed Target for Bolt Mount, M8x 1.25 Bolt included
CMCP200MK-B1-050	Keyed Target for Bolt Mount, 1/4-28 Bolt included, Pack of 50
CMCP200MK-B2-050	Keyed Target for Bolt Mount, M8x 1.25 Bolt included, Pack of 50

Examples



CMCP200MK with CMCP-MB10 Magnet Base and CMCP786A Accelerometer with CMCP632L-XX-02 Cable Connector Assembly



CMCP200MK with Emerson/CSI's A0643TX-EX Triaxial Accelerometer with Integral Magnet